

Mount your scope to your gun using one of the following methods:

- A. Use the provided Picatinny rail and mount as a single scope or as a clip-on in front of your optical scope.
- B. Hand-held using the provided lanyard.
- C. A third clip-on option is to use the M43 x 0.75 clip-on feature (not supplied.)

Aligning the scope, Live fire is required

- A. A thermal target and heated pads are supplied. Assemble per the instructions and set them at the preferred distance for shot alignment. Activate the thermal pad. Note: the thermal pad should not be activated until you're ready for it.
- B. Zoom the scope to maximum magnification, then go to the Main menu, select Freeze Mode.
- C. Align the reticle at the target center and fire one round.
- D. Recenter the reticle aimed at the target center and press the select button. Use the 4 navigation buttons to move the reticle to the point of impact. Note: If needed, use a second thermal pad to see the shot location. The reticle is now aligned to the shot location.
- E. When completed, press M once to exit. Note - given slight movements of the gun while shooting this process should be repeated until the shot location aligns with the reticle.

A complete detailed User Guide is available at:
www.angrystag.com/support/thermalscopemanual



Thermal Scopes Quickstart Guide



Get to Know Your Scope

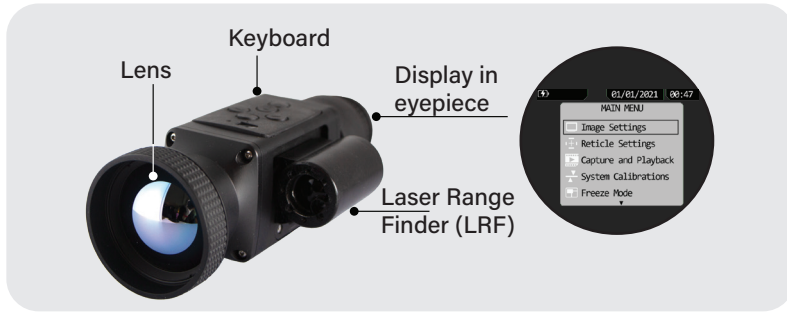

Navigation and Button Functions

At the top of the unit there is a 5 button keyboard to navigate the scope's options and applications. In addition to navigating the applications, the buttons have special functions.

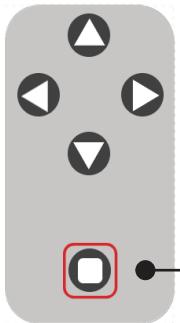

Turn on
Press and hold the until a screen appears, about 5 sec.
Turn off
Press and hold until Power Off is shown on the screen, about 5 sec.

M - Main Power/Menu Button

Native Button Functions

Thermal Calibration (NUC)

-Press/hold 2 sec

Laser Range Finder (LRF)

-Momentary press
LRF activation
(when installed)

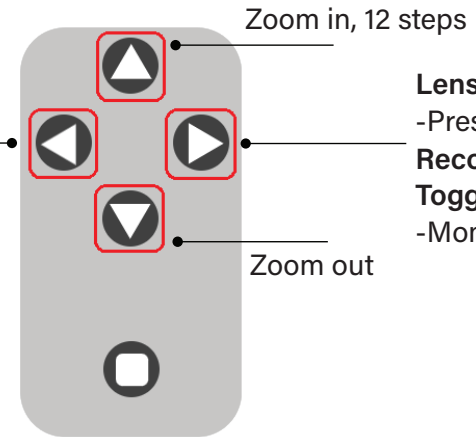

Lens Calibration

-Press/hold 2 sec

Record/Snapshot Toggle

-Momentary press

Navigation - press menu button and buttons change to navigation



M (Menu), Select

-Press 1 sec to exit menu

Menu Navigation

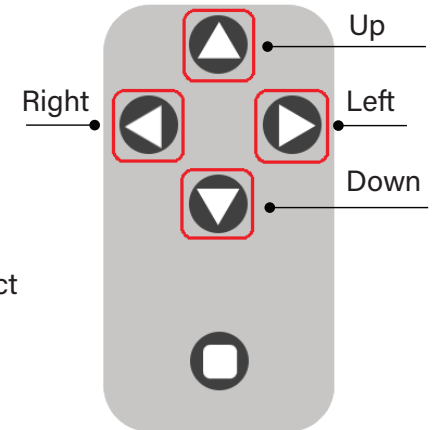

Charging

Use the supplied 2A Adapter. Charge for 4 hours before use.

